



# GLASS CLEANING PRODUCT USE MANUAL





# TABLE OF CONTENTS

Glass Cleaning is More Than Just Windows..... 4-5

Prep for Performance .....6

Clean with Confidence .....7

Finish Strong.....8

Reach Higher .....9

Maintain to Perform.....10

Stay Sharp .....11

Laundry Guide .....12

Product Portfolio Summary .....13



# GLASS CLEANING IS MORE THAN JUST WINDOWS

Windows, mirrors, and glass surfaces are an important part of the aesthetics of any professional space and often raise awareness about overall facility cleanliness. Rubbermaid Commercial Products® (RCP) Glass Cleaning Tools provide an ergonomic and effective streak-free clean for every glass surface.



## HIGHER PRODUCTIVITY

Using a 14" microfiber washer, 14" squeegee, and bucket is 48% faster cleaning than using a trigger sprayer and general rag.\*



## QUICK-CONNECT COMPATIBILITY

Quick-Connect handles make cleaning more efficient in every area of the facility. The unique connection mechanism allows for easy, quick tool exchange, allowing cleaning staffs to change from mopping to glass cleaning in seconds.



## IMPROVED ERGONOMICS

Soft grip ergonomic handle delivers more comfort for long shifts.

\*Based on 2023 Official ISSA Cleaning Times



# A COMPLETE SYSTEM OF GLASS CLEANING PRODUCTS

## GLASS MICROFIBER WASHER

Engineered for performance, the Glass Microfiber Washer combines superior absorbency with durable construction for fewer trips to your bucket and more time cleaning. Designed to withstand repeated use, it helps professionals clean efficiently job after job, with an integrated edge scrubber to tackle stubborn dirt in hard-to-reach areas.



## GLASS SQUEEGEE

The Glass Squeegee delivers streak-free results with every pass. Featuring a soft rubber blade that glides effortlessly over glass, ensuring a spotless, professional finish on the first try.



## GLASS CLEANING BUCKET AND LID

Bucket fits 18-inch Microfiber Washer and Squeegee for easy cleaning of large surfaces, and has volume indicator graduated fill lines for a precise fill every time.



## 4 INCH GLASS SCRAPER

Angled scraper helps remove sticky residue, like stickers, tape, or paint splatter, in hard-to-reach areas.



## GLASS MICROFIBER CLOTH

Designed with premium microfiber construction that leaves no trace of scratches or lint residue behind on glass or mirrored surfaces.



# PREP FOR PERFORMANCE SET THE STAGE FOR A STREAK-FREE SHINE

## PREP

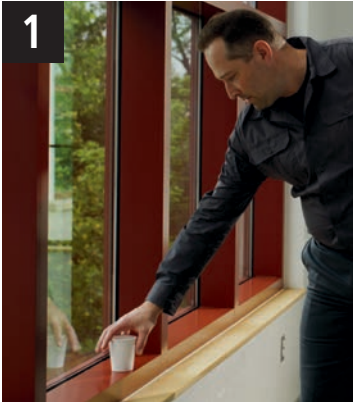

**REMOVE** obstacles and clear large debris from the working area.



**PREPARE** cleaning solution by adding the cleaning agent of your choice into the bucket.



**ADD** water using the graduated fill lines inside the Glass Cleaning Bucket.

# CLEAN WITH CONFIDENCE WASH AWAY DIRT FOR A CLEARER VIEW

## WASH



**DIP** Microfiber Washer into the soapy solution, then wring it out to reach preferred saturation level.



**START** at the top, placing the Washer on the glass.



**USE** even pressure and completely cover the glass in cleaning solution, washing the glass to remove dirt on the surface.



# FINISH STRONG FROM STUCK-ON TO STREAK FREE

## SCRAPE



**REMOVE** protective cover from scraper.  
**USE** Scraper to remove tough grime or stuck-on messes and sticky residue caused by tape or stickers.



**HOLD** at a slight angle and gently press the blade against the surface and glide the Scraper using smooth, even strokes.

## SQUEEGEE AND FINISH



**PIVOT** Squeegee to preferred angle. The Squeegee has two pivot points, vertically (0° and 45°) and horizontally (-45° to 45°), to handle tight angles and tricky glass shapes. The adjustable rotating head locks in any vertical position from 0° to 45° and in any horizontal position from 0° to 180°.



**START** at the top, placing the Squeegee on the glass.  
**KEEP** the Squeegee at a 20° angle to the glass and work in an S-shape from top to bottom



**USE** slightly overlapping strokes to remove liquid from the surface.



**FINISH** by detailing with a HYGEN™ Microfiber Glass Cloth to dry the edges and absorb any remaining water.

# REACH HIGHER CLEAN EVERY INCH WITH CONFIDENCE



**ATTACH** the Microfiber Washer to a Quick-Connect Handle.



**EXTEND** the handle to the length needed for higher windows.  
**SCRUB** the wet surface using the Microfiber Washer.



**USE** the Quick-Connect release buttons to swap the Microfiber Washer with the Squeegee.



**REMOVE** liquid from the surface by making slightly overlapping strokes with the Squeegee.

# MAINTAIN TO PERFORM CLEAN, REFRESH, AND REUSE



**REMOVE** dirt and debris from your Microfiber Washer to ensure it's ready for your next clean.



**UNFASTEN** the hook and loop patch and slide the Microfiber Washer Sleeve off the T-bar.



**WASH** in a standard laundry machine for thorough cleaning.  
**DRY** Microfiber Washer Sleeves on low heat (130°F/54°C) setting.  
**DO NOT** use fabric softener or dryer sheets.

# STAY SHARP REPLACE BLADES FOR CONSISTENT CLARITY

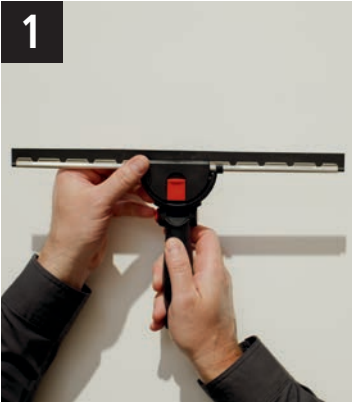

**CHECK** the condition of your Squeegee blade for cracks, rips, or tears.



**REPLACE** by unlocking the latch on the back of the Squeegee.



**REMOVE** the steel channel.

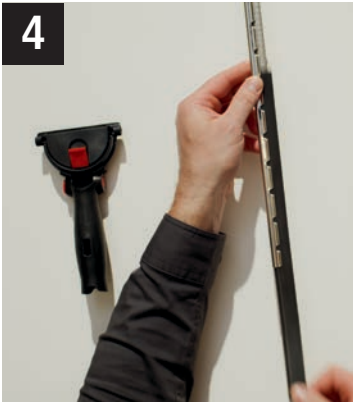

**SLIDE** out the rubber blade and set aside.



**INSERT** the new replacement Squeegee blade into the steel channel and make sure the flat edge is facing outward.  
**ALIGN** the steel channel with the Squeegee handle.



**LOCK** the latch back into place, making sure the teeth on the underside of the latch grip the rubber blade securely.



LAUNDRY GUIDE

THE FOLLOWING STEPS ARE RECOMMENDED TO PROPERLY LAUNDER AND TAKE CARE OF YOUR MICROFIBER:

1.



CLEAN the laundry machines daily and before the first use.

2.



SEPARATE soiled Rubbermaid Microfiber Cloths and Mops from other textiles at the point of contamination.

3.



DETERMINE detergent and maximum load size using chart on the right.\*

WASHER SIZE	MAX VOLUME	DETERGENT/ BLEACH USAGE**	# OF 18" MOPS	# OF 16" x 16" CLOTHS	# OF 12" x 12" CLOTHS
60 lb. / 27.2 kg	71.8 gal. / 272L	1.5 oz / 2.0 oz	130	200	350
81.6 lb. / 37 kg	97.8 gal. / 370L	2.0 oz / 2.7 oz	175	270	470
101.4 lb. / 46 kg	121.3 gal. / 459L	2.6 oz / 3.4 oz	220	340	600
125 lb. / 56.7 kg	150.6 gal. / 570L	3.1 oz / 4.2 oz	270	415	730
141.4 lb. / 64.3 kg	169.6 gal. / 642L	3.5 oz / 4.7 oz	305	470	820
174.8 lb. / 79.3 kg	201 gal. / 761L	4.4 oz / 5.8 oz	375	580	1015

(Quantity will vary with machine size and type. Fill to 90-100% of capacity.  
Detergent: 30-60% Alkali; Bleach: 8.5% sodium hypochlorite)



For higher level of clean and added layer of assurance, use chlorine bleach, as applicable. Confirm with chemical supplier for correct quantity<sup>1</sup>

4.



WASH Rubbermaid Microfiber Cloths and Mops using the step-by-step guide on the right.<sup>2</sup>

OPERATION	WASH TEMP °F	WASH TIME	WATER LEVEL
Break/Bleach	165	25 min.	Med: 14.4 gallons
Rinse	80	2 min.	Med: 14.4 gallons
Rinse	80	3 min.	Med: 14.4 gallons
Extract	N/A	5 min.	N/A

(Exact time/speed may vary depending on machine type and/or operating condition)



Pre-rinse/soak: Mops/cloths may require pre-rinses/soaks to open fibers and loosen soil  
Washing with Cold Water: chlorine bleach is required, refer to measurements in prior step



Water Quality: Soft water (zero grains hardness); low to moderate alkalinity (0–100 ppm @Na2O); no iron in water

5.



COMMERCIAL DRYING

- Dry cloths and mops on low heat (130°F/54°C) setting
- Remove dry textiles from the dryer immediately
- Store dry cloths and mops in clean Rubbermaid Cube Truck



REQUIRED CARE

- Do not store Rubbermaid Cloths or Mops in a washing machine overnight
- Do not use fabric softener
- Do not use dryer sheets

\*Machine settings can be established by chemical provider.  
\*\*Represents 1/2 the average manufacturer's detergent recommendation. Using full amount of detergent can result in hazy floors.

Always follow the protocol as directed by your facility manager.  
<sup>1</sup>Follow manufacturer instructions for bleach use.  
<sup>2</sup>Per CDC Guidelines for healthcare facilities.

SQUEEGEES

NO.	COLOR	DESCRIPTION	L x W x H	CASE QTY
2221955	BLACK	10 IN. GLASS SQUEEGEE	9.8" x 7.6" x 1.6"	6
2221950	BLACK	14 IN. GLASS SQUEEGEE	13.8" x 7.6" x 1.6"	6
2221949	BLACK	18 IN. GLASS SQUEEGEE	17.7" x 7.6" x 1.6"	6
2221948	BLACK	10 IN. GLASS SQUEEGEE REPLACEMENT (PACK COUNT: 5)	9.8" x 0.8" x 0.2"	6
2221947	BLACK	14 IN. GLASS SQUEEGEE REPLACEMENT (PACK COUNT: 5)	13.8" x 0.8" x 0.2"	6
2221953	BLACK	18 IN. GLASS SQUEEGEE REPLACEMENT (PACK COUNT: 5)	17.7" x 0.8" x 0.2"	6



MICROFIBER WASHERS

NO.	COLOR	DESCRIPTION	L x W x H	CASE QTY
2221954	BLACK	10 IN. MICROFIBER WASHER	11.2" x 7.3" x 2.2"	6
2221945	BLACK	14 IN. MICROFIBER WASHER	15.2" x 7.3" x 2.2"	6
2221957	BLACK	18 IN. MICROFIBER WASHER	19.1" x 7.3" x 2.2"	6
2221956	GRAY	10 IN. MICROFIBER WASHER SLEEVE	11.6" x 2.8" x 1.4"	6
2221960	GRAY	14 IN. MICROFIBER WASHER SLEEVE	15.4" x 2.8" x 1.4"	6
2221959	GRAY	18 IN. MICROFIBER WASHER SLEEVE	19.3" x 2.8" x 1.4"	6



ADDITIONAL TOOLS

NO.	COLOR	DESCRIPTION	L x W x H	CASE QTY
2221952	BLACK	4 IN. GLASS SCRAPER	7.6" x 4.3" x 1.4"	6
2221946	BLACK	SCRAPER REPLACEMENT BLADE PACK (PACK COUNT: 20)	6.5" x 1.2" x 0.5"	6
FGQ63000BL00	BLUE	GLASS MICROFIBER CLOTH	16.0" x 16.0"	12
2221958	YELLOW	GLASS CLEANING BUCKET AND LID	21.9" x 11.8" x 10.6"	6



GLASS CLEANING STARTER KIT

NO.	COLOR	DESCRIPTION	CASE QTY
2221951	VARIOUS	GLASS CLEANING STARTER KIT	1





CMRC0361 | 0126 © 2026 Rubbermaid Commercial Products LLC | 8900 Northpointe Executive Park Drive, Huntersville, NC 28078  
To see our complete line, visit our online catalog at [RubbermaidCommercial.com](https://www.RubbermaidCommercial.com)